



GET THE RIGHT AMOUNT OF CORK FOR YOUR CLIMATE



Minimum Exterior Cork Thickness To Use For R-13 & R-21 Split Insulated Walls To Maintain Mold Index < 3 For Specified West Coast Climate Zones (CZ)

Use Top Numbers For 2x4 (R-13) and 2x6 (R-21) Construction W/Class III Vapor Retarder
Use Bottom Numbers If Using Class I Interior Vapor Barrier Where Acceptable

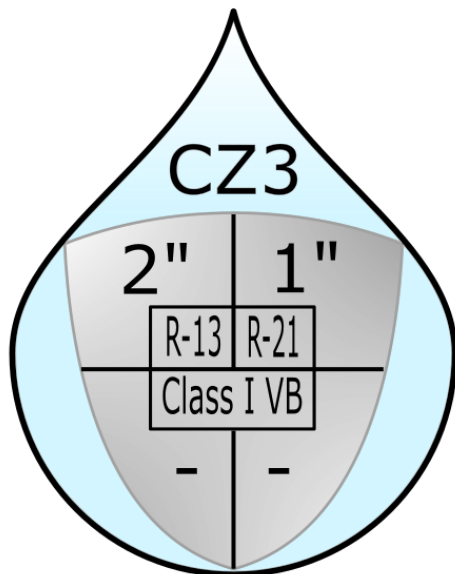

ex. Los Angeles, California

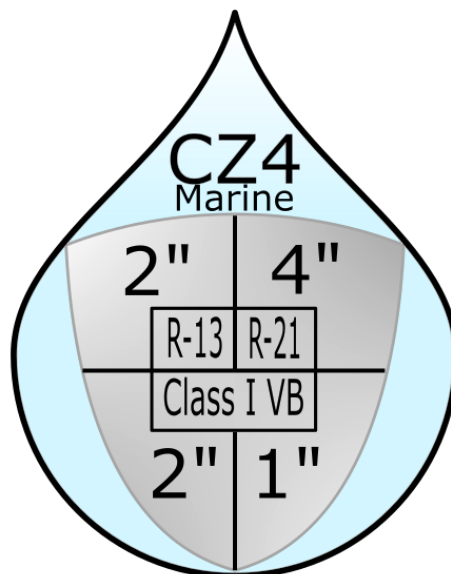

ex. Portland, Oregon

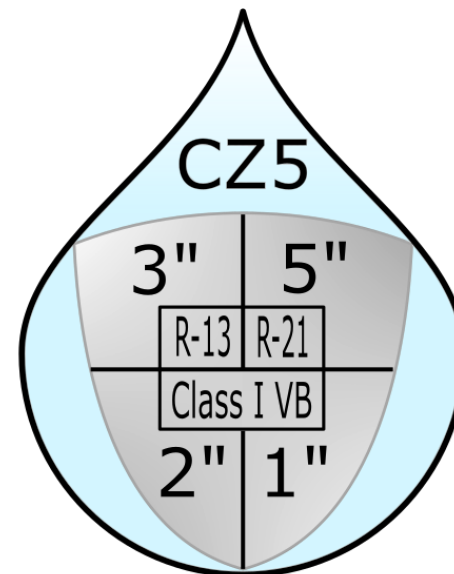

ex. Vancouver, British Columbia

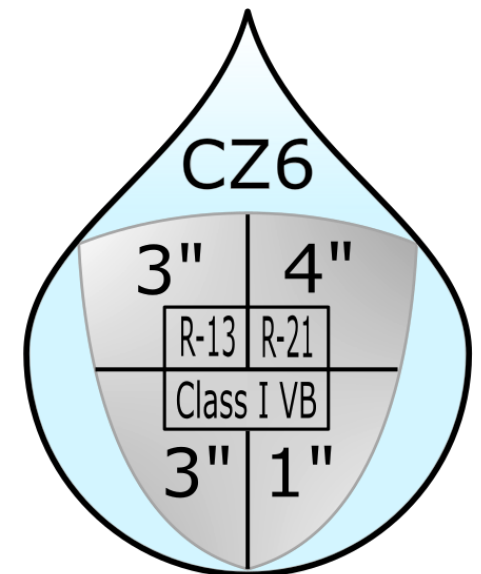

ex. Billings, Montana

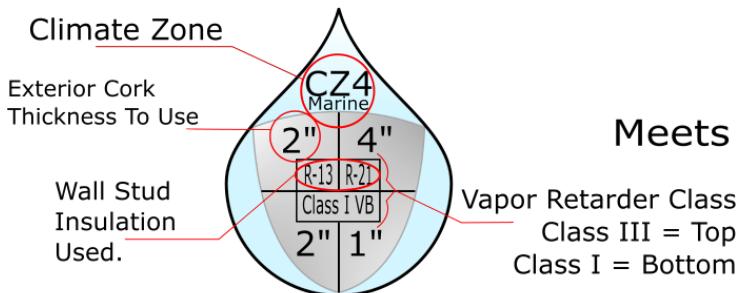

Example: Climate Zone 4 With R-13 Inside Walls Would Use At Minimum 2" Exterior Insulation

Meets Or Exceeds IECC Minimum Whole Wall Insulation Requirements
Don't Know Your Climate Zone? Find This And More At:

www.smallplanetssupply.com/thermacork